

MAV - Macro Valve

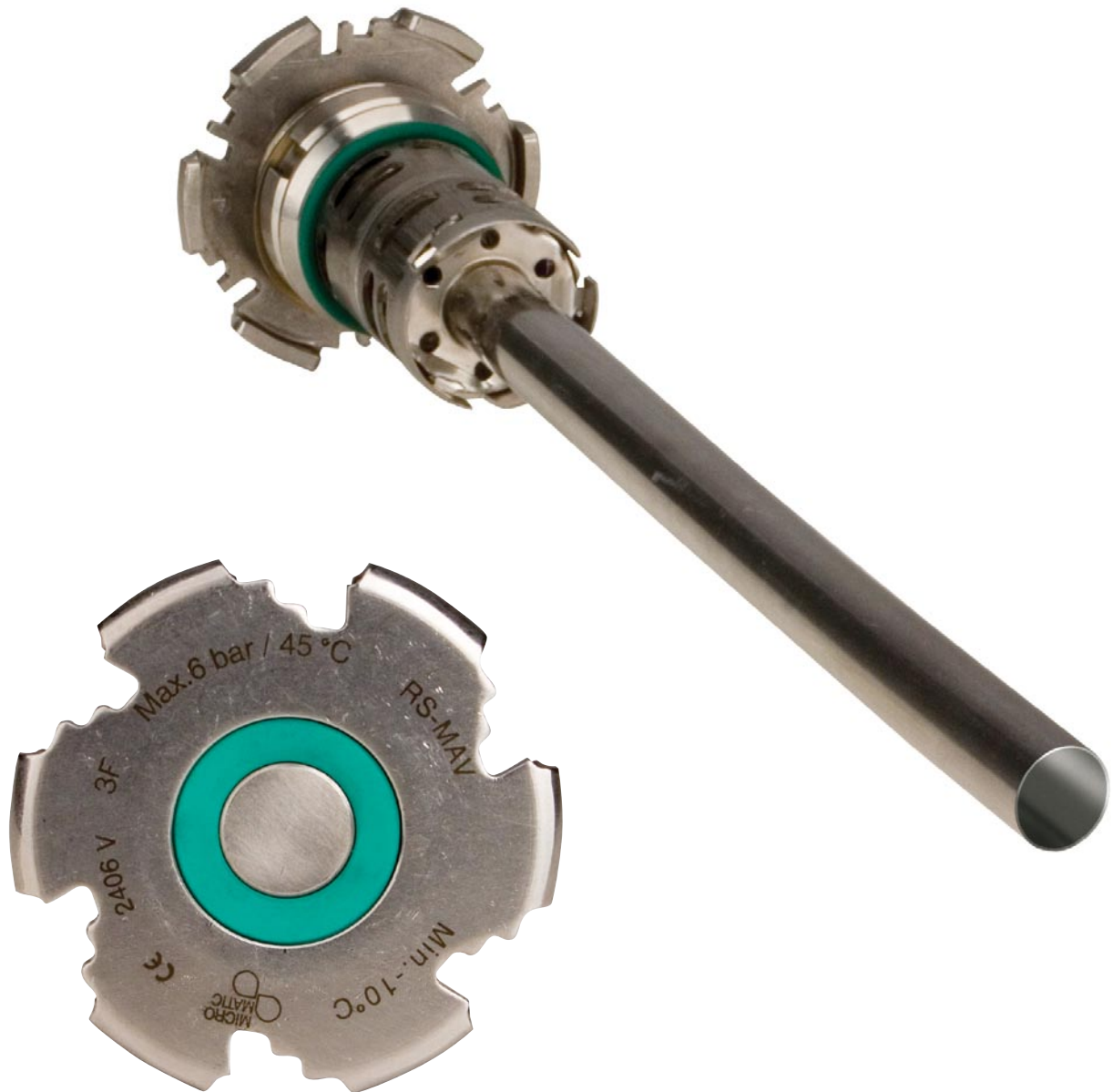

Servicing Instructions

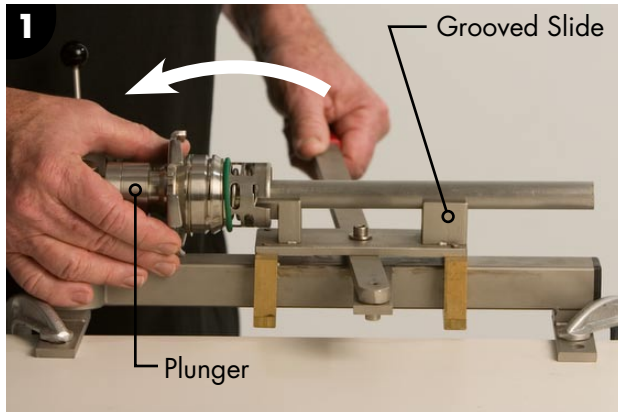

Place extractor valve into grooved slide section of bench tool #740-003.

Move bench tool lever towards the plunger.

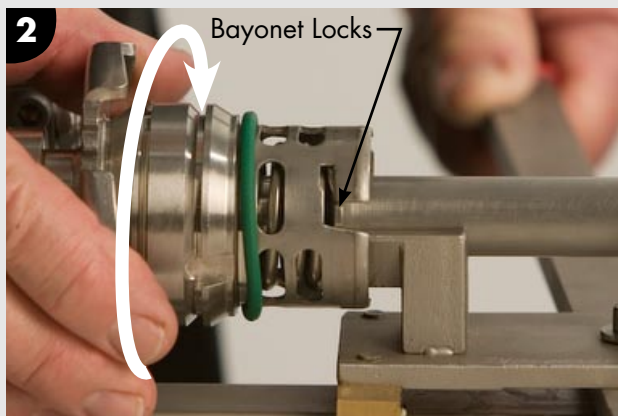

Maintaining firm lever pressure, rotate the valve body to disengage the three bayonet locks located on the valve body.

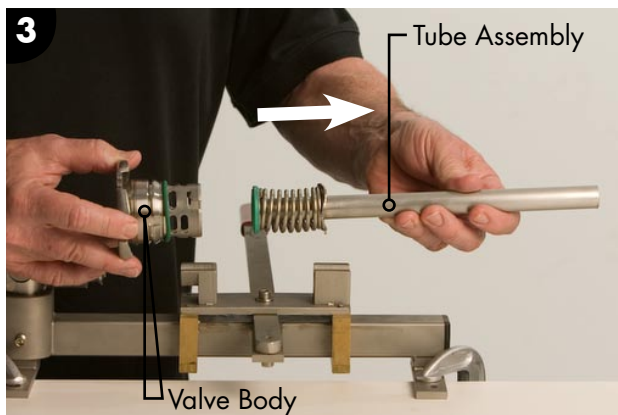

Remove MAV Valve from bench tool and separate valve body from tube assembly.

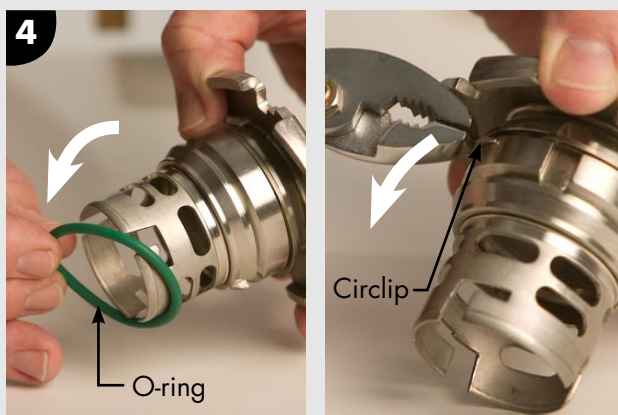

Remove O-ring and Circlip from valve body.

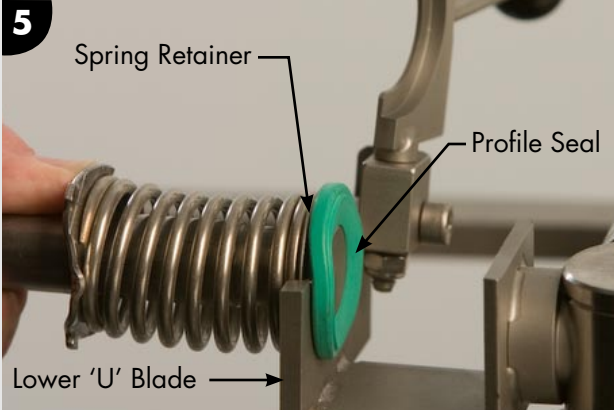

Remove the profile seal by placing the spring retainer and the profile seal on opposite sides of the lower 'U' blade located on the Bench Tool.

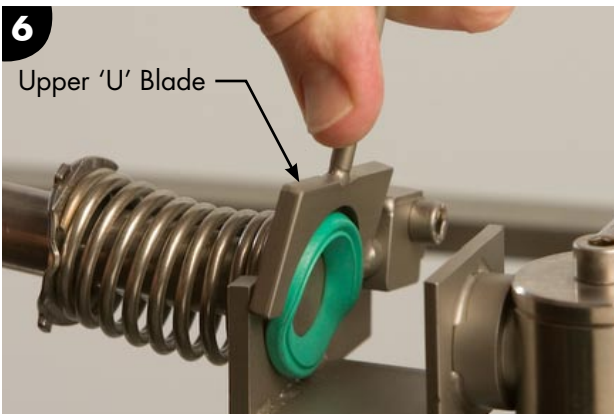

Lock the upper 'U' blade between spring retainer and profile seal.



Push forward to remove profile seal.

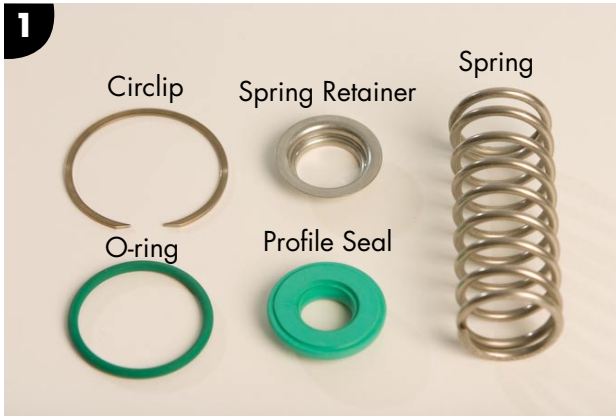

MAV extractor valve replacement parts. Do not reuse old components.

Clean tube and body in soap solution to remove dirt and debris before valve is assembled.



Using a new spring, spring retainer and profile seal, create the tube assembly.

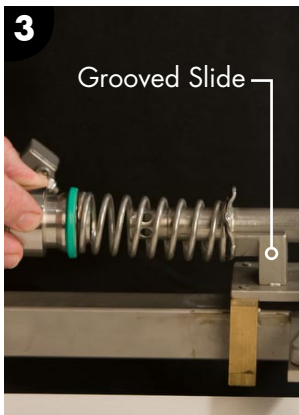

Place tube assembly into the grooved slide section of the bench tool.

NOTE: Pre-moisten profile seal in clean water.

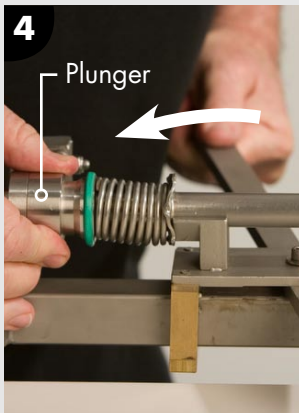

Move bench tool lever towards the plunger to install new profile seal over the ventil on the tube assembly.

Repeat the motion if necessary to ensure the proper installation of the profile seal.

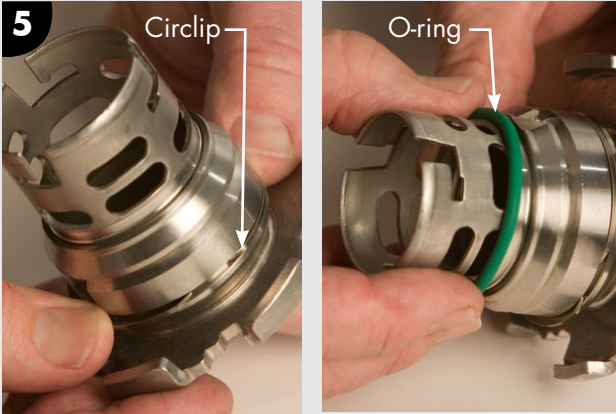

Install new Circlip and O-ring on valve body.

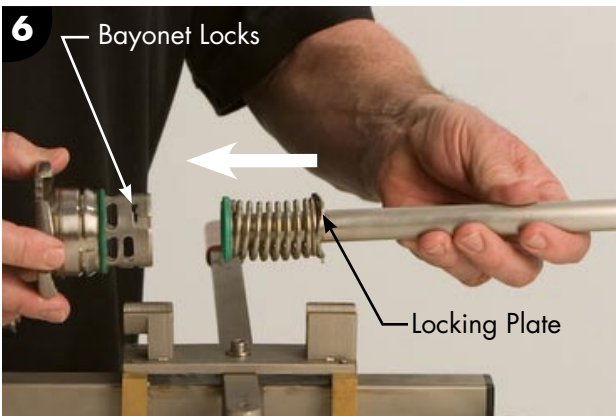

Position tube assembly into valve body ensuring that the locking plate is lined up with the three bayonet locks.

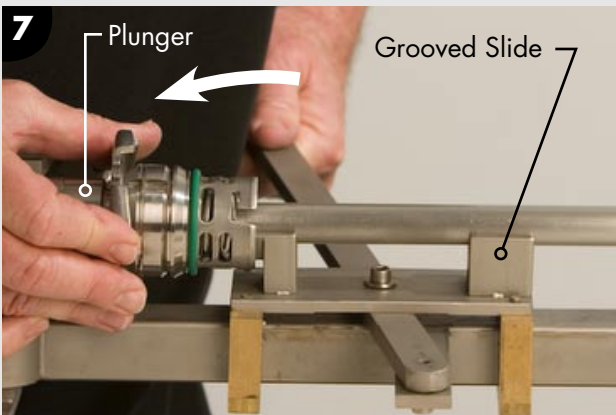

With the extractor valve properly located in the grooved slide section of bench tool, move bench tool lever towards the plunger to depress profile seal.

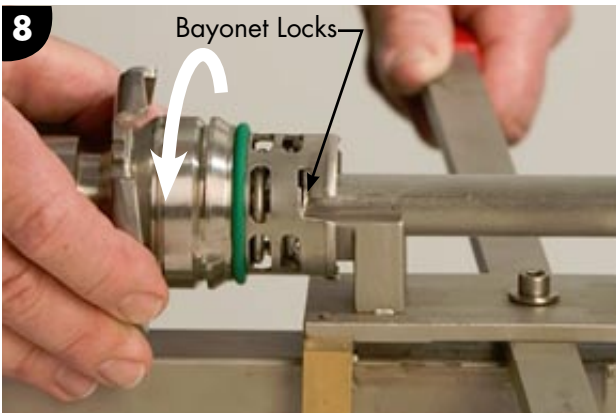

Twist valve body to re-engage bayonet locks between valve and tube assembly.

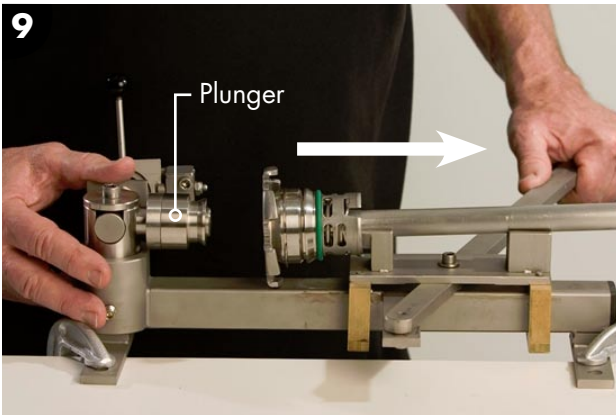

Move the bench tool lever away from plunger and remove extractor valve assembly.



Correctly assembled extractor valve.

NOTE: It is recommended to pressure test the extractor valve when fitted into a container.

For additional information,
visit www.ipi-global.com
or call +44 1844 354789.