

## MAV - Macro Valve

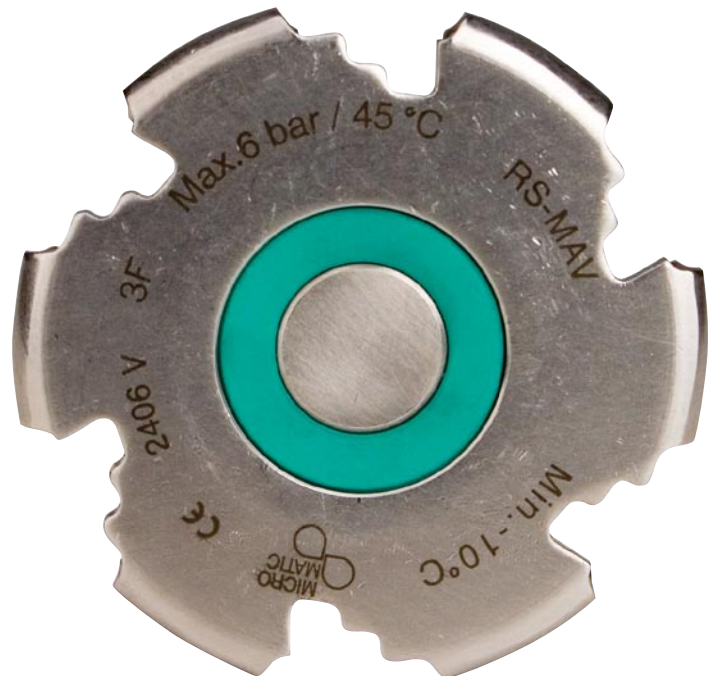

## Installation & Removal Instructions



Check container neck with Go Gauge #001-619.

Go Gauge should fit completely down inside container neck as shown.

If Go Gauge does not fit in neck, do not use container.



Install Tamper Evident Ring

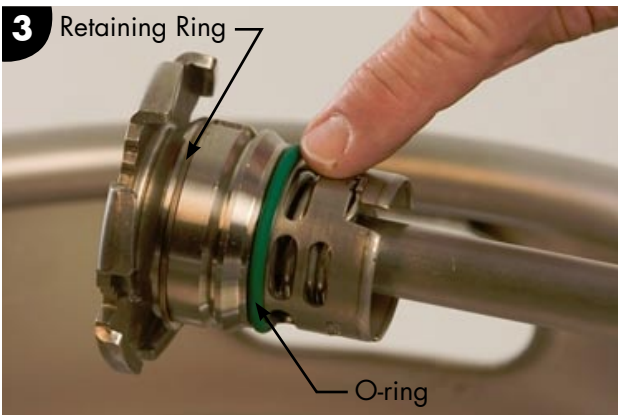

Inspect extractor valve O-ring and Retaining Ring for damage.



Dip extractor valve in a bucket of clean water prior to mounting.

**Note: If water can not be used during the installation procedure, please call your Micro Matic representative.**



Place extractor valve into container neck.

Turn the extractor valve clockwise until it drops.

Now turn the extractor valve 1/2 turn clockwise until it drops again and locks in place.



**IMPORTANT: It is necessary to seat the extractor valve properly in the neck prior to step 7.**

Press down on extractor valve as shown.

While pressing down, rock the palm of your hand in a circular pattern. This will center the retaining ring evenly across area 2 on the container neck.

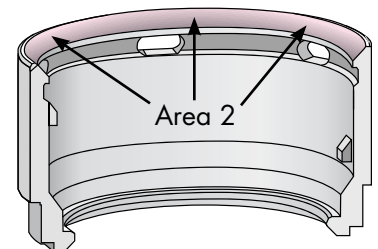

Place Spindle Tool #740-076 over the extractor valve as shown.



Lock the extractor valve securely in place by turning the spindle handle clockwise until no more clicks are heard.

Loosen the spindle handle until free, rotate the Spindle Tool 1/2 turn and retighten to insure no clicks are heard.

Remove Spindle Tool.



Verify that the extractor valve has been installed correctly by using the Verification Tool #741-043. Place the service tool on the extractor valve flange and rotate it 1/6 of a turn clockwise.

Using controlled force, move (rock) the Verification Tool side to side and back and forth as illustrated.

An incorrectly seated valve will come loose during this operation. If necessary, repeat steps 6, 7, 8 and 9.



Option - Pressurized Leak Testing by using the MAV Pressure Test Head #748-XXX.

For additional information, visit [www.ipi-global.com](http://www.ipi-global.com) or call +44 1844 354789.



Install Dust Cap as shown.

Turn clockwise to lock in place.



Install Red Tamper Evident Pin #102-423.

Push red pin down until it is flush with surface of dust cap.

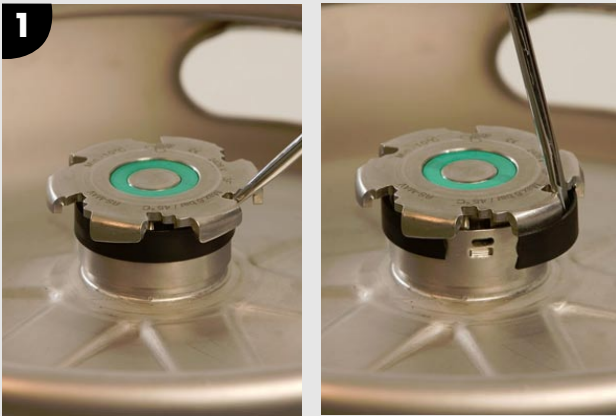

Break and remove Tamper Evident Ring.

Place screw driver blade between extractor valve flange and Tamper Evident Ring.

Pry out on tamper evident ring until it breaks.



Degas container with MAV Degas Head #748-XXX.

**CAUTION: During degassing wear protective clothing, gloves and safety glasses as required.**

For additional information, visit [www.ipi-global.com](http://www.ipi-global.com) or call +44 1844 354789.



Place the Valve Releasing Tool #740-078 so that the six pins fit into the six corresponding holes in the container under the extractor valve flange.



Squeeze the Valve Releasing Tool handles gently to compress the Circlip.

**CAUTION: Do not use excessive force as it will damage the tool.**



Place the Lifting Tool #740-077 on top of the Valve Releasing Tool.



Turn Lifting Tool #740-077 handle clockwise until the extractor valve moves up.

**CAUTION: Do not use excessive force as it will damage the tool.**

Remove Lifting Tool and set aside.



With your free hand pull up while turning clockwise on extractor valve until it is free from the container.