

# MAV - Macro Valve Coupler



## User Instructions



Remove Dust Cap by turning counter clockwise.



Align MAV Coupler pins with slots in MAV Valve.



Check that coupler handle is in the off/closed (up) position.

Connect the coupler to the extractor valve and turn the coupler 1/6 of a turn clockwise until it stops.



Push down on the handle to engage the coupler. If engaged correctly, the handle will lock into position.

**CAUTION: The handle cannot be pushed down if the coupler is incorrectly connected to the valve. If necessary repeat to steps #2 thru 4.**

Typical vapour recovery system.

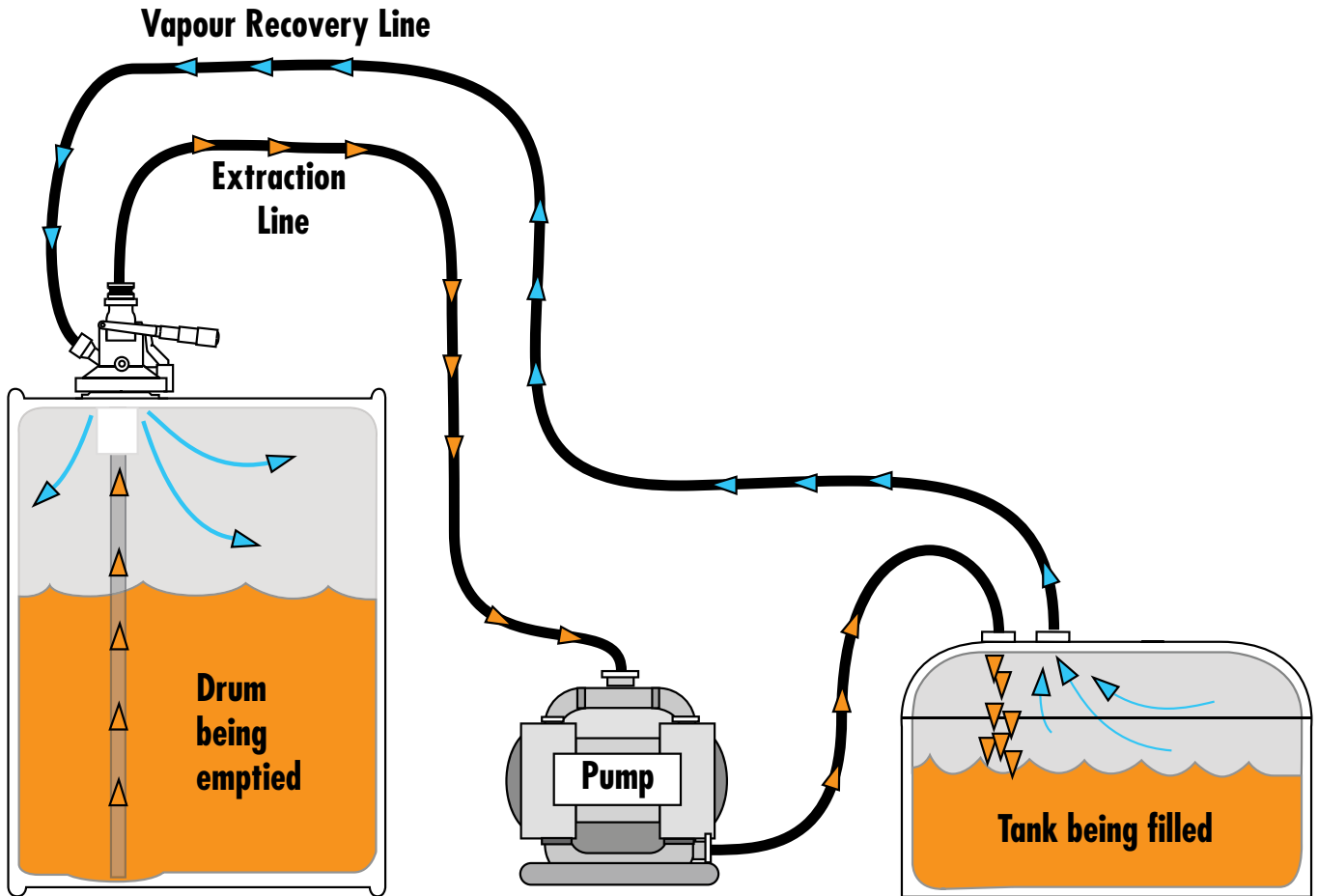

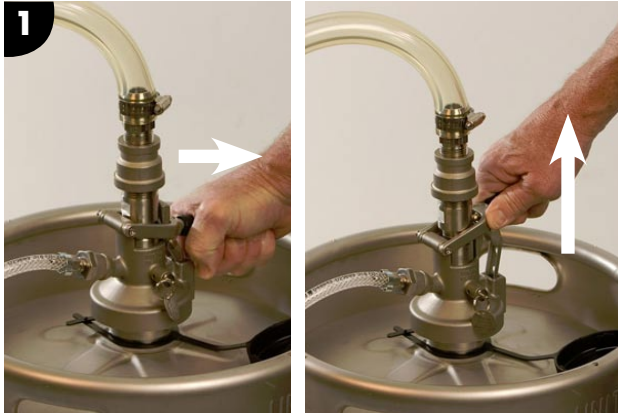

To unlock the coupler, pull the handle outward.  
The handle will move to the up (closed) position.  
The system is now closed.



Turn the coupler 1/6 of a turn counter clockwise until it stops.  
The coupler can now be removed.



MAV Coupler and Rinsing Socket.

Typical rinsing system.

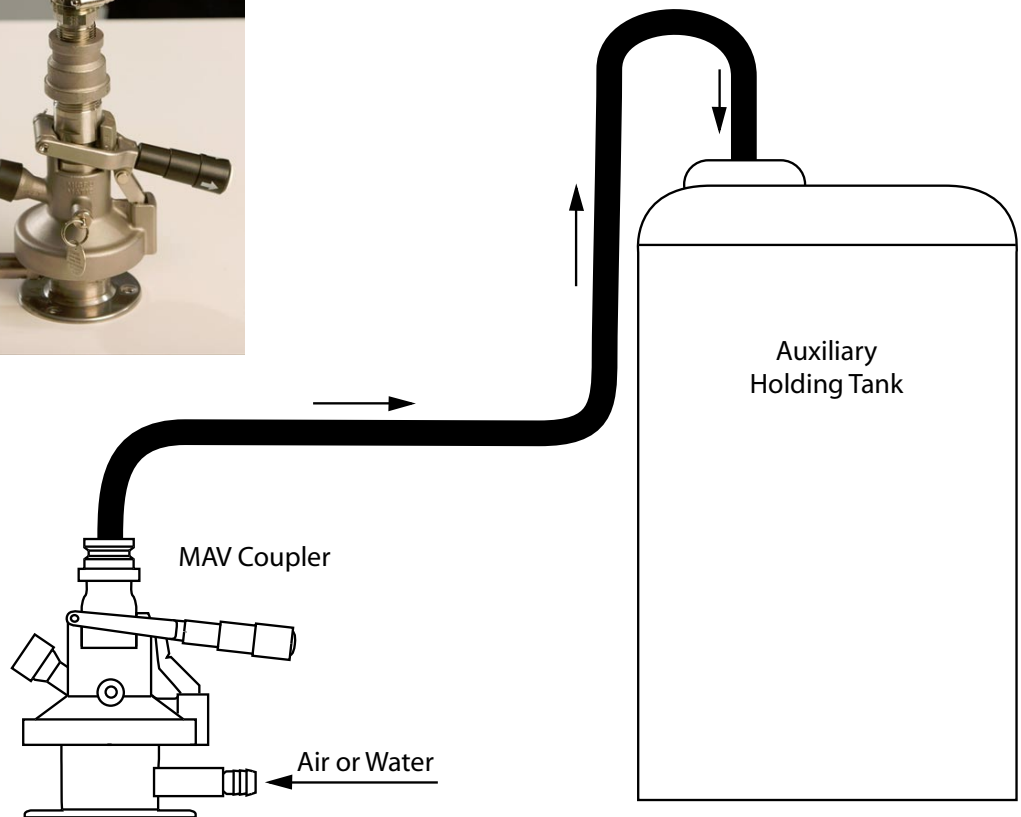



MAV Coupler with vapour recovery hose attached.



MAV Coupler with Filter attached.



MAV Coupler with threaded adaptor attached.

**CAUTION: If threaded adaptor is used, discard the filter.**



The MAV Coupler Mounting Bracket secures the coupler when not in use.