

DV - Drum Valve

Heavy Duty Servicing Tools

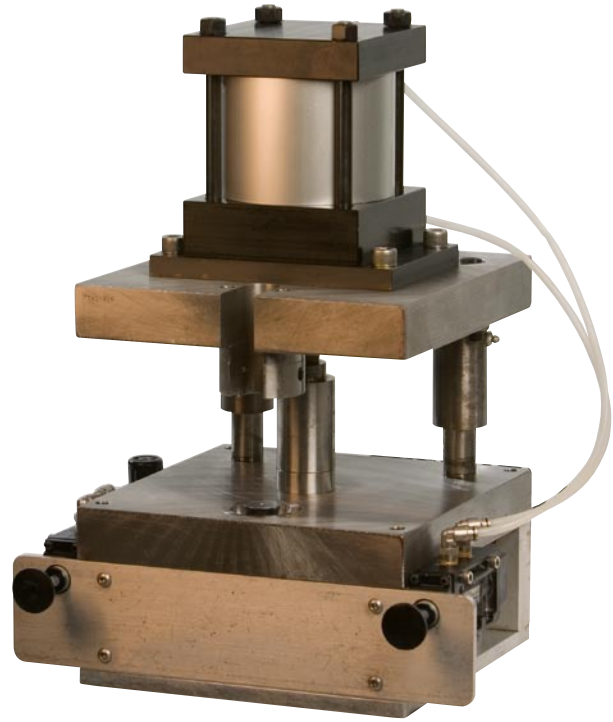

2" BSP



56x4



2.5x5



70x6

User Instructions

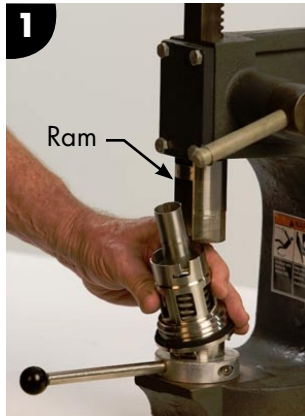

Place Drum Valve on base of #740-907 Final Assembly tool.

Align tube assembly of Drum Valve with groove in ram of Final Assembly Tool.

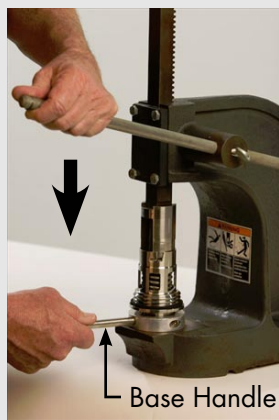
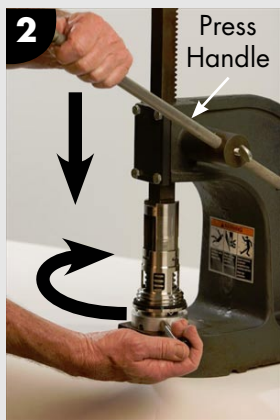

While applying downward pressure on the Final Assembly Tool press handle, rotate the base handle clockwise to disengage the three bayonet locks located on the valve body.



Remove Drum Valve from Final Assembly Tool.



Separate tube from valve body.



Remove square seal and discard.

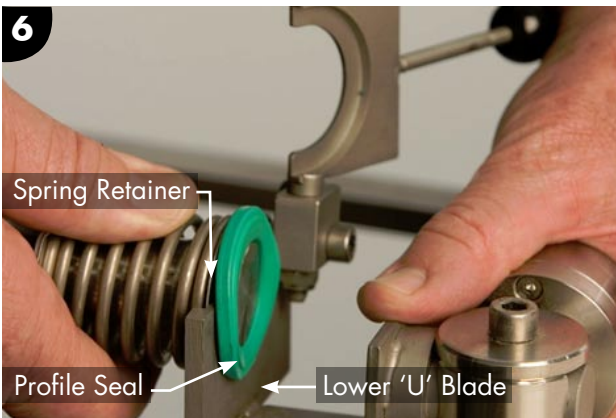

Using the #741-093 DS-DV Bench Tool, remove the profile seal by placing the spring retainer and the profile seal on opposite sides of the lower 'U' blade located on the Bench Tool.

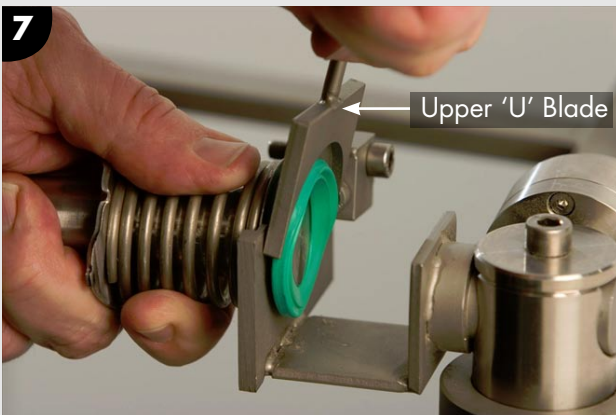

Lock the upper 'U' blade between spring retainer and profile seal.

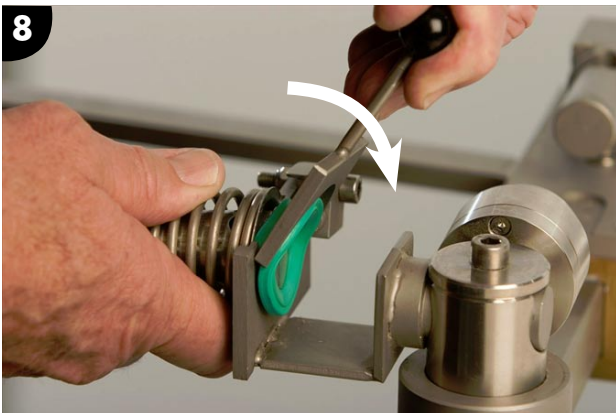

Push forward to remove profile seal.

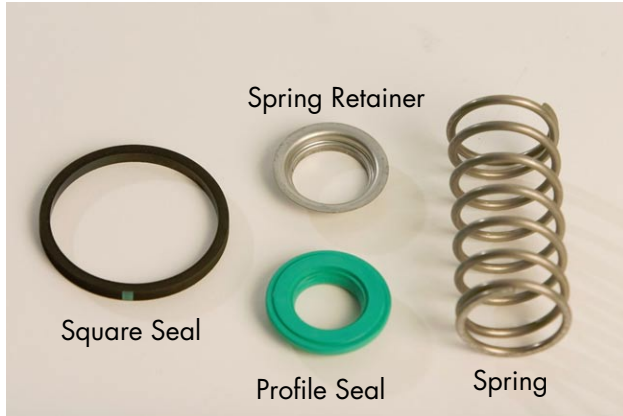

Drum Valve replacement parts.



Lubricate spring retainer and profile seal with silicon lubricant.



Using a new spring, spring retainer and profile seal, create the tube assembly.



Remove the arbor from the base of #740-906 Valve Assembly Tool.

Slide the spring retainer and profile seal onto the arbor.

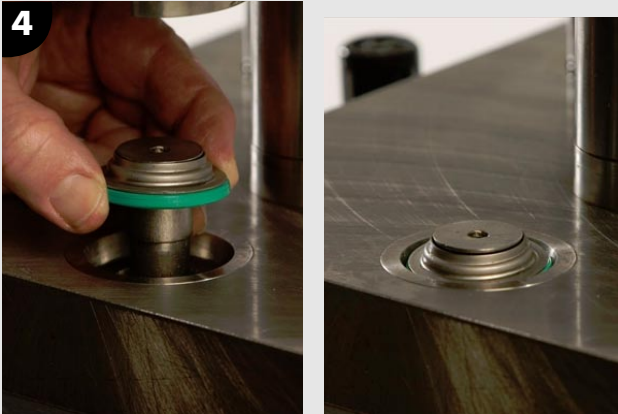

Insert the arbor with spring retainer and profile seal into the base hole of the Valve Assembly Tool.



Place down tube and spring on top of spring retainer.

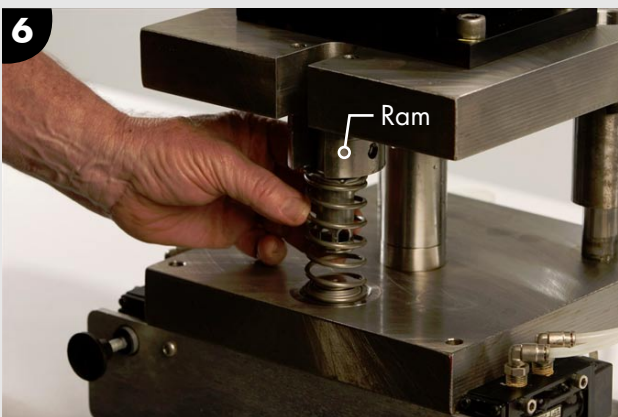

Align down tube within the slot of ram.

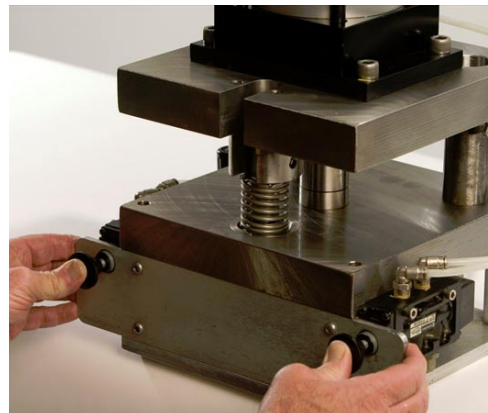
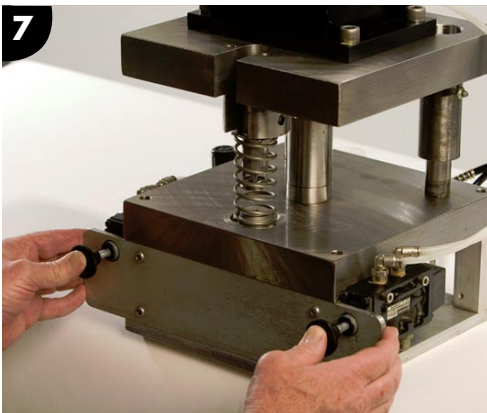

Press the two buttons on the Valve Assembly Tool as shown. Keep all foreign objects clear from tool.

Caution: Serious bodily injury may occur if assembly tool is not operated as shown.

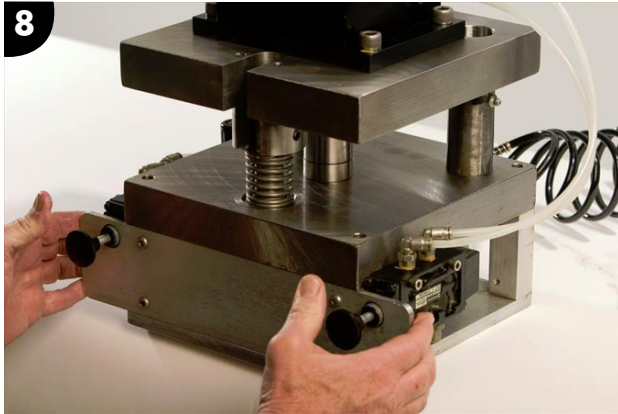

Release the two buttons on the Valve Assembly Tool.



Remove the sub-assembly from the Valve Assembly Tool.



Inspect profile seal on vent to ensure uniform positioning.

Repeat steps 7 & 8 if seal is incorrectly positioned.

Note: Arbor should remain in fixture if steps 7 & 8 are repeated.



Install new square seal on Drum Valve body.



Place Drum Valve main body and the tube sub assembly on the base of Final Assembly tool.

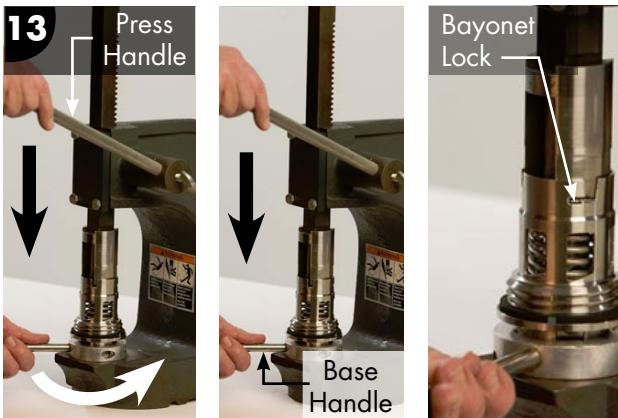

While applying downward pressure on the Final Assembly Tool press handle, rotate the base handle counter clockwise to engage the three bayonet locks located on the valve body.



Remove completed Drum Valve from the Final Assembly tool.



Correctly assembled Drum Valve.