

# DV - Drum Valve

## DVC 2400 Coupler

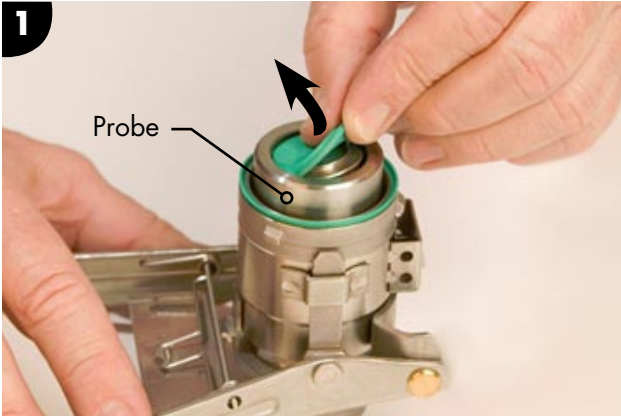

## Servicing Instructions



Remove dry break seal from probe and discard.

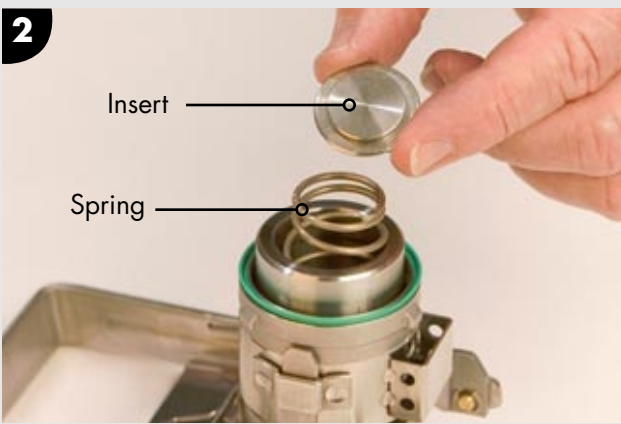

Remove insert and discard.



Remove spring from probe and discard.



Remove main seal from coupler body and discard.



Disassemble coupler by removing c-clips and clevis pins in order to replace o-ring seal.

**Note: This step and steps 6 and 7 in disassembly and steps 1, 7 and 8 in assembly do not apply to couplers with rivets.**

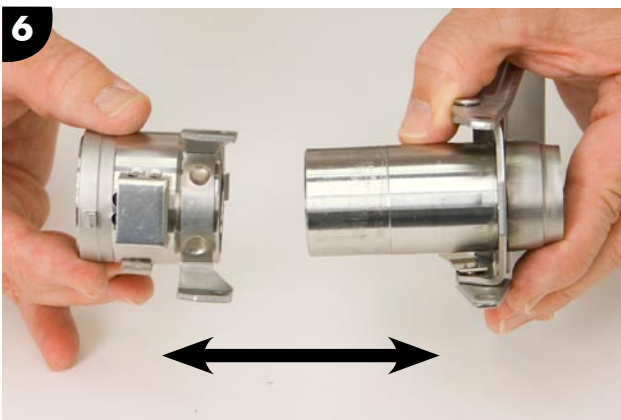
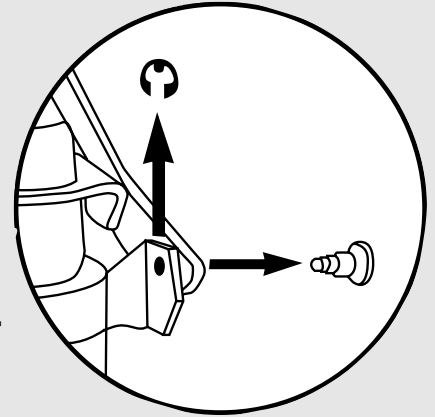

Separate probe assembly from coupler body.

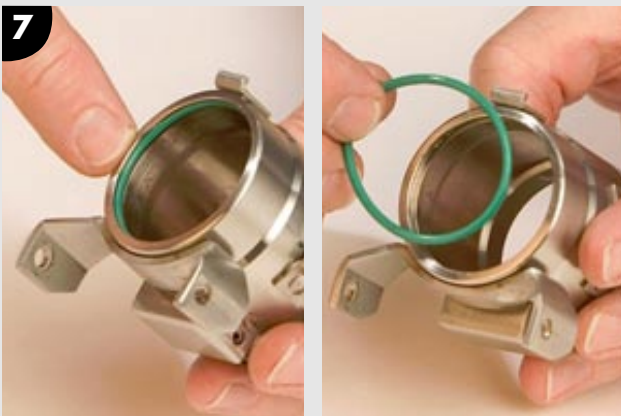

Remove O-ring seal from coupler body and discard.



DVC 2400 Viton Seal Kit.



1 Install new o-ring seal into groove.

**Note: Lubricate o-ring seal with silicon lubricant prior to installation.**



2 Turn coupler body upside down.

Clean main seal groove.

Install new main seal.



3 Install spring by placing the largest end of spring into the probe and wiggle in a clockwise direction while pressing down firmly.



Install new dry break seal on insert.

**Note: Seal must be secured over groove on insert for proper installation.**

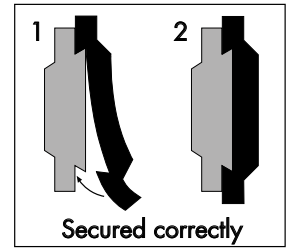

Place new dry break seal assembly on spring.



Press the new dry break seal assembly firmly into the probe until the dry break seal locks into place.

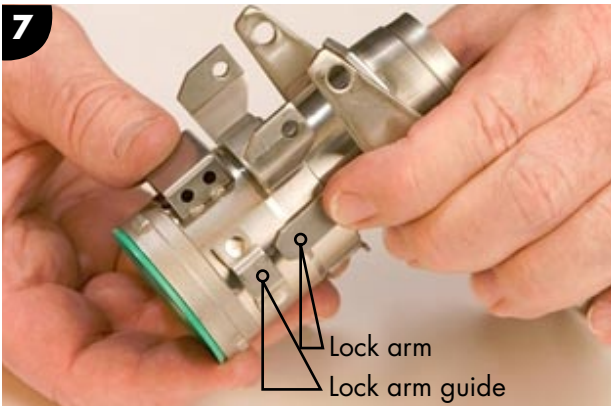

Push probe assembly into coupler body.

Slide lock arm into lock arm guide.

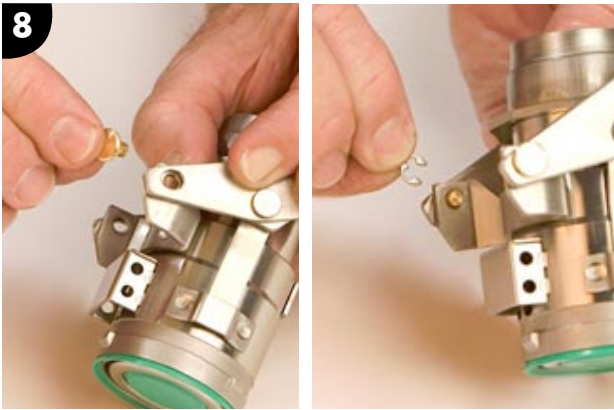

Install clevis pins and c-clips as shown.

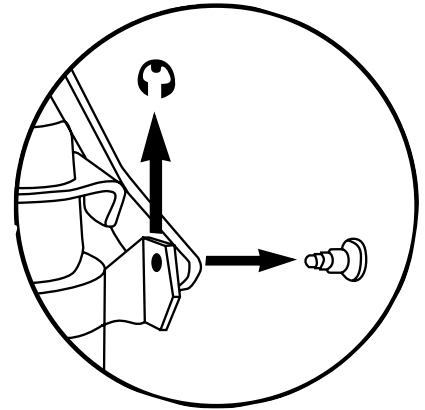

Correctly assembled coupler.